

N.Z. BUILDING PROGRESS

Published Monthly by the Proprietors, Harry H. Tombs Ltd.
 8 Farish Street ——— Wellington, New Zealand
 TELEPHONE 1651 P.O. BOX 481.

Annual Subscriptions:—To any address 7/6 post free. Note: 1/- will be allowed on this account if paid in advance.

Remittances should be made by Post Office or Money Order. All cheques, plus exchange, to be made payable to Harry H. Tombs Ltd., and sent direct to P.O. Box 481, Wellington.

All communications to be addressed to "The Proprietors, Progress," Box 481, Wellington."

Advertising Rates will be sent on application. The value of "Progress" as an advertising medium is rapidly becoming recognized by advertisers. Circulation considered it is the cheapest advertising medium of its kind in the Dominion.

To Our Advertisers—All copy for advertising matter must be in our hands by the 1st of the month preceding publication, otherwise no responsibility with regard to insertion will be undertaken.

The Editor will at all times be glad to receive Illustrated Articles on subjects of interest for consideration, provided the articles are short and to the point, and the facts authentic.

Should subscribers continue to receive copies of this journal after expiry of current year, it will be accepted as an intimation that they are desirous of subscribing for a further period of twelve months.

In case of change of address, or irregularity of this paper's delivery, subscribers should send immediate notice.

Publisher's Announcements.

Our 50th Competition

We offer a prize of £1 1 0 and a second prize of 10/6 for the Essay judged to be the best on

"The Quality of Fitness in Architecture."

Students are invited to write a short essay on the above subject. Among the various points to be considered are the suitability, or fitness, of different materials for the positions they are placed in, or the uses to which they are put. The fitness or otherwise, say, of designing a building for the centre of a city in the style of a country cottage; or a mansion in the Tudor style for a suburban section. The transgressions against this quality are so frequent and glaring, that there should be no trouble in criticizing them, but on the other hand, competitors are required to point out how and where attention has been and can be paid to it.

Length of Essay not to exceed 2000 words. Points will be given for original matter; practical application of the "quality," literary style, punctuation, grammar and spelling. Students are advised to read "Essentials in Architecture" by John Belcher, A.R.A. (5/-).

Mr. Basil B Hooper, A.R.I.B.A., of Dunedin has kindly set this subject.

Essays must be sent in under a non-de-plume, addressed to **Progress**, 8 Farish St., Wellington, and marked clearly "Fiftieth Prize Competition" on outside with a covering letter giving competitors's name, and address of employer. Designs to be sent in by January 10th.

Our 51st Competition

We offer a prize of £1 1 0 for the design adjudged to be the best for a

Motor House

with accommodation for two large sized cars and facilities for cleaning and general repairs. Building to be fire-resisting. No limit to cost, but lavish expenditure to be avoided. Building to be situated in clay

bank about ten feet high with unlimited width and depth. Drainage and ventilation must be shown and explained. Access to back of garage from upper level is also required.

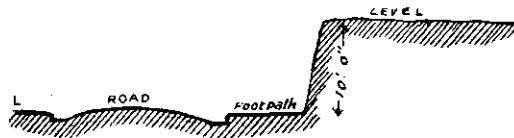

Drawings required: Plan, elevation and two sections to 1/4-inch scale.

Mr. Wm. Fielding, Architect, of Wellington has kindly set this subject.

Designs must be sent in, in black and white under a non-de-plume, addressed to **Progress**, 8 Farish Street, Wellington, and marked clearly "Fifty-first Prize Competition" on outside with a covering letter giving competitor's name, and address of employer. Designs to be sent in by February 10th. 1917.

Our 52nd Competition

We offer a prize of £1 1s. 0d. and a second prize of 10/6 to the two best designs submitted for

Banking Premises

(A problem to illustrate the value of Axial Planning), in accordance with the following conditions:—

One of the leading Banks propose erecting a new branch building in the foremost city of the Dominion: the site chosen is situated at the juncture of two principal streets.

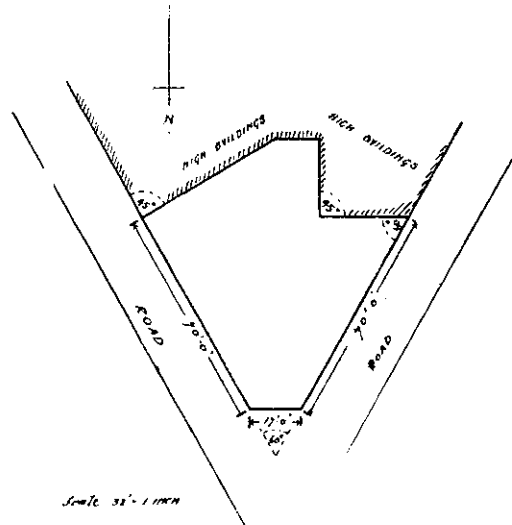

It is desired that the banking chamber shall extend as nearly as possible the full width of the site, and also that the same shall be symmetrical. In this instance a corner entrance must be arranged for, and no columns or piers are to occupy the floor space of the chamber.

The accommodation required must include in addition to the banking chamber, manager's room with fireplace, staff toilets and cloak rooms for both sexes, stationery room, staff luncheon room with small kitchen, living room and bedroom for janitor. The first floor to be so arranged with offices that it will be suitable for rental purposes, proper accommodation must be provided for both sexes in the way of lavatories etc., and a separate tenant's entrance given from the street.

There is further accommodation that should be provided for in modern banking premises, and the student is invited to include in his design any other features he may

(Continued on page 827)