

# PLAN OF THE BLACKWATER GOLDFIELD, N. Z., 1913.

Showing Mining Areas, Position of Main Lodes, and Topography

Compiled by the Mines Department, from Official Surveys.  
(T.O. Bishop, A.O.S.M., Inspector of Mines)

Scale of Chains

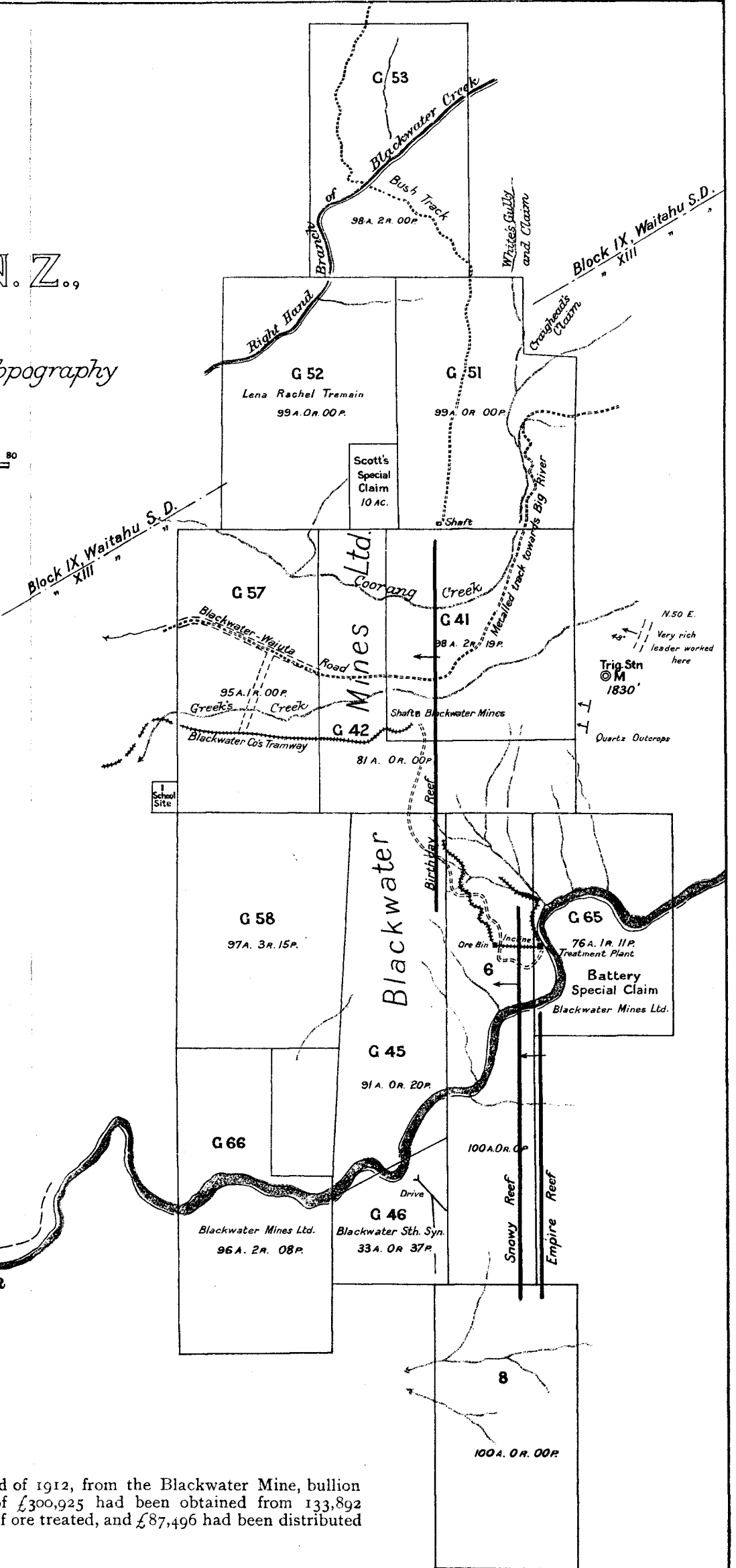
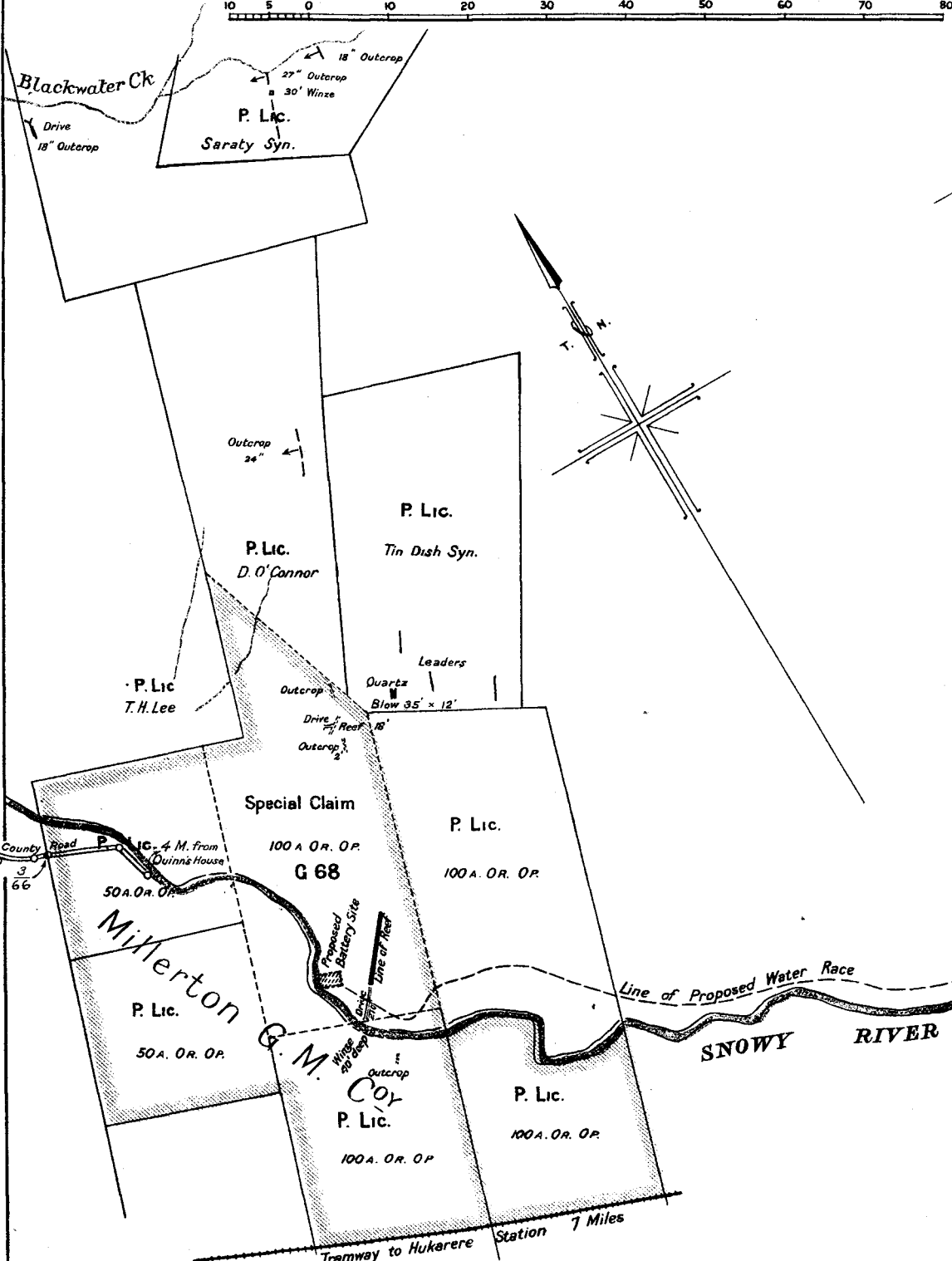

NOTE.—At the end of 1912, from the Blackwater Mine, bullion to the value of £300,925 had been obtained from 133,892 Imperial tons of ore treated, and £87,496 had been distributed in dividends.