

1878.  
NEW ZEALAND.

---

MAPS OF THE NORTH AND MIDDLE ISLANDS OF  
NEW ZEALAND,

SHOWING

1. THE RAILWAYS ALREADY AUTHORIZED BY PARLIAMENT.

2. THE RAILWAYS NOW PROPOSED.

*Laid on the Table by the Hon. Mr. Macandrew, with the leave of the House.*

---





# SKETCH MAP OF THE NORTH ISLAND OF NEW ZEALAND

Public Works Department

1878

John Blackett, M. Inst. C.E.  
Engineer in Charge

Drawn by A. Koch.

### REFERENCE.

- Railways open for traffic.
- Railways in course of construction
- Railways Contract survey made
- Railways Preliminary survey made
- Roads made
- Water Races

C. Reinga  
C. Maria  
van Diemen

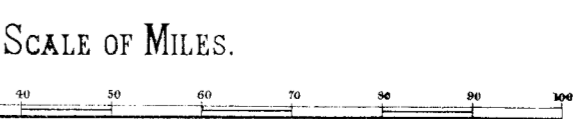
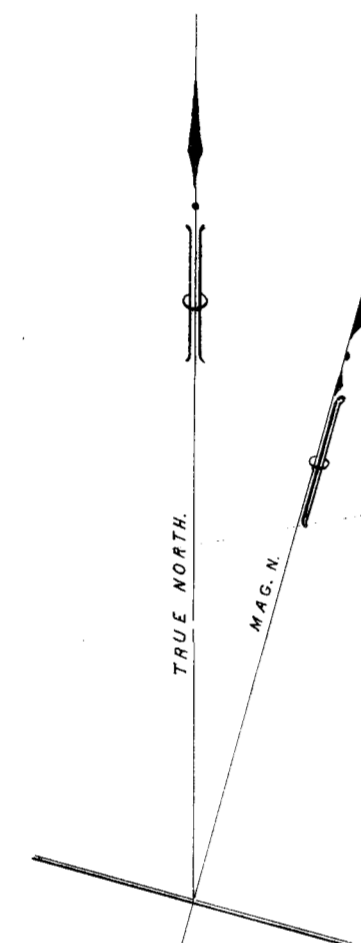

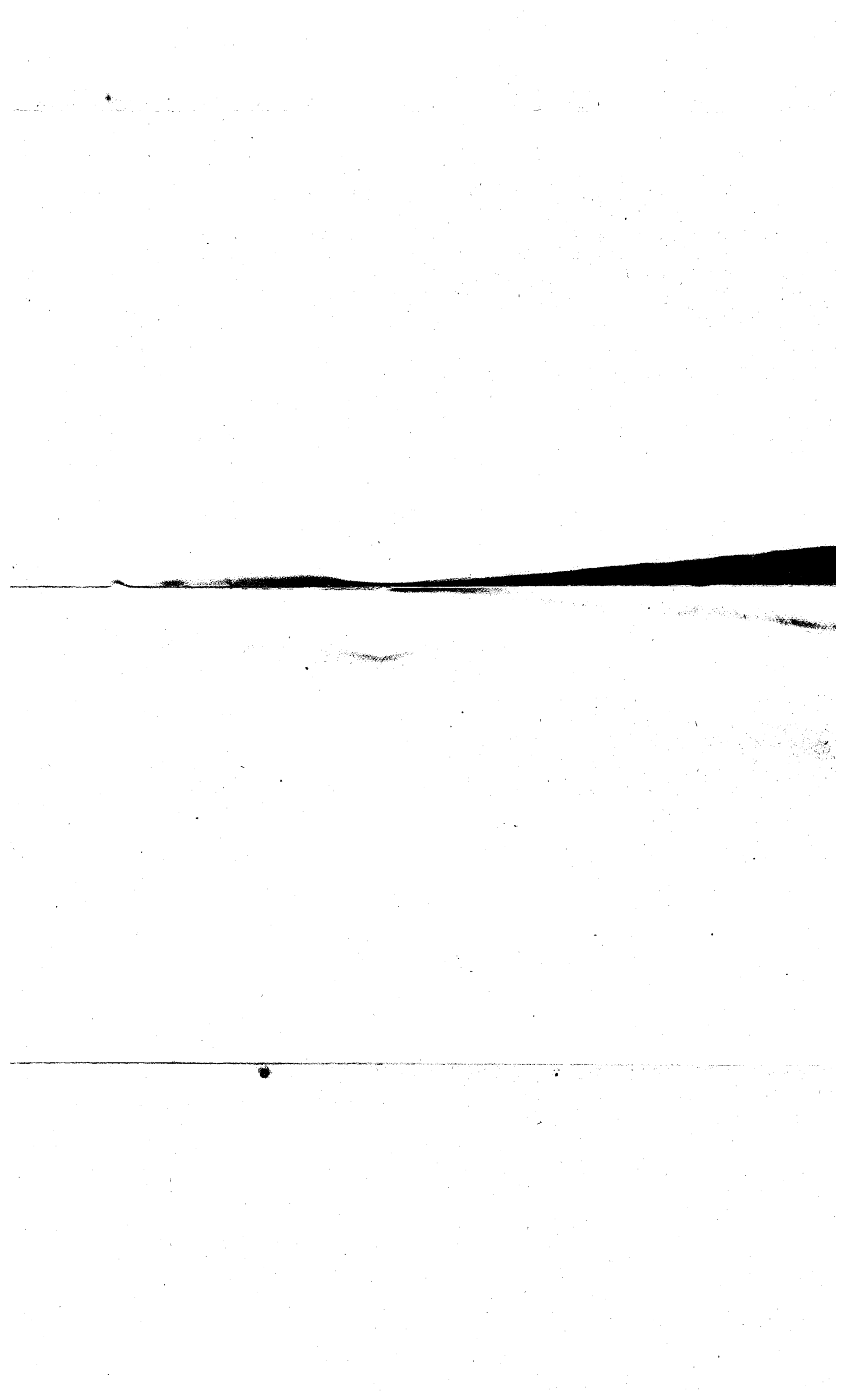

# SKETCH MAP OF THE MIDDLE ISLAND OF NEW ZEALAND

Public Works Department

1878

W.N.Blair. M.Inst. C.E.  
Engineer in Charge

Drawn by A.Koch.

## REFERENCE.

Railways open for traffic.  
Railways in course of construction  
Railways Contract survey made  
Railways Preliminary survey made  
Roads made  
Water Races

